



SERVICE INSTRUCTION

SI-32-08
Revision 0

TITLE: 4-Hole Pattern Axle – Main Gear Leg

SUBJECT / REASON / DESCRIPTION:

The FBA-2C1 and FBA-2C2 airplanes have a “socket” type axle on the main gear. This type of axle installation does not allow for any adjustment of camber. Found Aircraft has redesigned the lower end of the main gear leg to accept a 4-hole pattern cantilever-type axle.

COMPLIANCE:

Compliance is optional.

EFFECTIVITY:

All Found FBA-2C1, FBA-2C2 airplanes

APPROVAL:

This modification has been approved by FAC Engineering and TCCA where applicable.

MANPOWER REQUIREMENTS:

It is estimated that the modification will take approximately 16 hours if work is performed by experienced personnel.

SPECIAL TOOLS / EQUIPMENT:

None Required

PARTS LIST (BILL OF MATERIALS):

Kit FAC-SI-32-08A Rev 0

Part Number	Description	QTY.
U4011 or Q4011	Main Gear Leg	2
U3019	Axle Shim	2
U3015	Axle	2
MS21206-5	High Strength Washer	4
MS21206-6	High Strength Washer	4
NAS1804-5	12 pt Nut	4
NAS1804-6	12 pt Nut	4
MS21206C5	High Strength Washer CKS	4
MS21206C6	High Strength Washer CKS	4
NAS625-26	12 pt Bolt	4
NAS626-26	12 pt Bolt	4
MS21025-24	Axle Nut	2
MS24665-368	Cotter Pin	4

Parts for Optional Heavy Duty Wheel and Brake Installation

Kit FAC-SI-32-08B Rev 0

Part Number	Description	QTY.
30-52N	Caliper Kit (Cleveland)	2
069-01900	Anchor Bolts (Cleveland)	4
40-75T	Wheel Assembly (Cleveland)	2

Parts for Optional Ski Trunnion Installation

(Required for ski installation on new gear legs)

Kit FAC-SI-32-08C Rev 0

Part Number	Description	QTY.
U2509	HD Ski Trunnion	2
U2551	Ski Spacer	2
NAS625-11	12 pt Bolt	8
MS21206C5	Washer CKS	8
MS21206-5	Washer	8
NAS1804-5	12 pt Nut	8

WEIGHT & BALANCE:

All the existing and new components are located at ARM = 0. Weigh removed components and weigh installed components. Update W&B for the difference in weight.

Found Aircraft Canada Inc.

95 Airport Rd., Seguin, Ontario, Canada, P2A 2W8
T (705) 378-0530 F (705) 378-0594

www.foundair.com

SI-32-08 Rev 0

14-Jul-12

Page 2 of 4

IMPLEMENTATION INSTRUCTIONS:

1. Remove main gear fairings, Ref. MM 32-10.
 2. Remove the main gear leg, Ref. MM 32-11.
 3. Remove wheels, calipers and torque plates, Ref. MM 32-40.
Note: Heavy Duty wheels and brakes are required for reinstallation
 4. Retain puck stack and hardware for reinstallation.
 5. Assemble U4011 or Q4011 gear leg per Figure 1.
 6. Torque 5/16 axle bolts to 190-235 in-lbs and torque 3/8 axle bolts to 335-420 in-lbs.
 7. Install assembled gear leg, Ref. MM 32-11.
 8. Install wheels, Ref. MM 32-40.
 9. Bleed brakes ,Ref. MM 32-42, and carry out an operational check of wheels and brakes.
 10. Reinstall main gear leg fairing, Ref. MM 32-10.
- Note: The brake fairings can not be installed on the new gear legs.

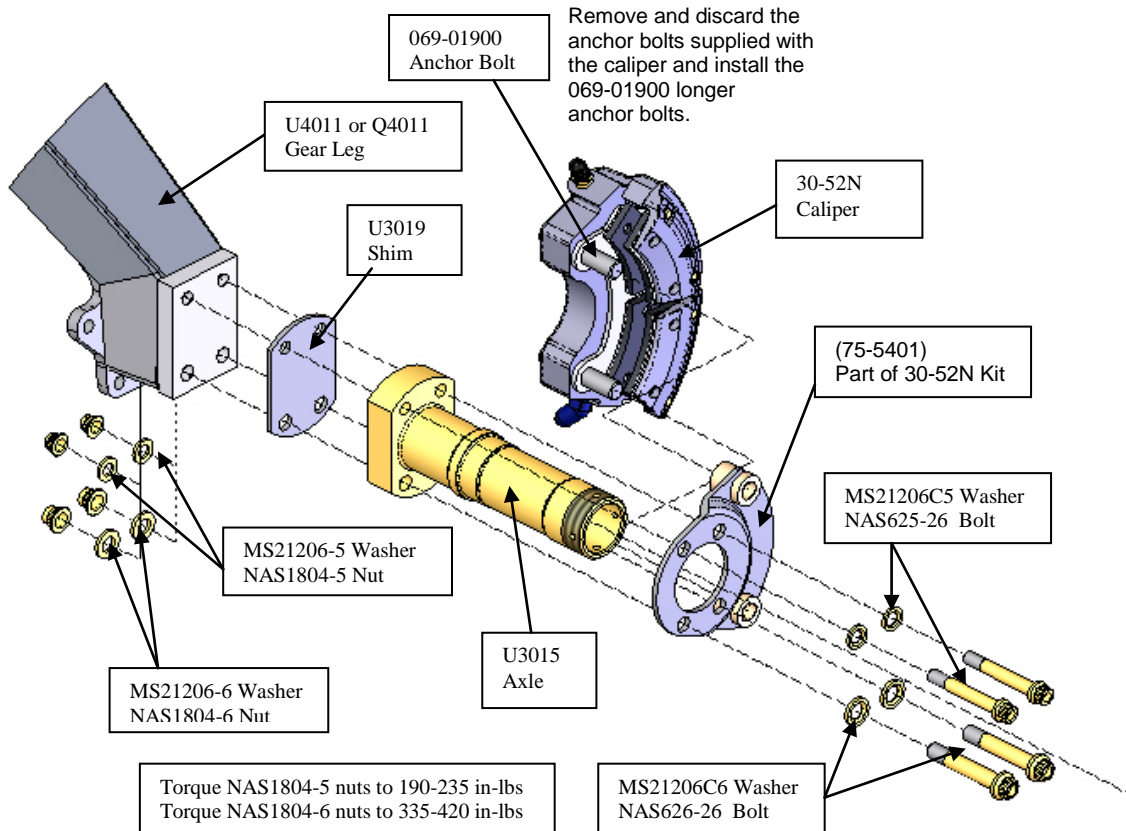

Figure 1 Axle and Caliper Installation

IMPLEMENTATION INSTRUCTIONS: (Optional Ski Trunnion)

1. Install ski trunnion per Figure 2.

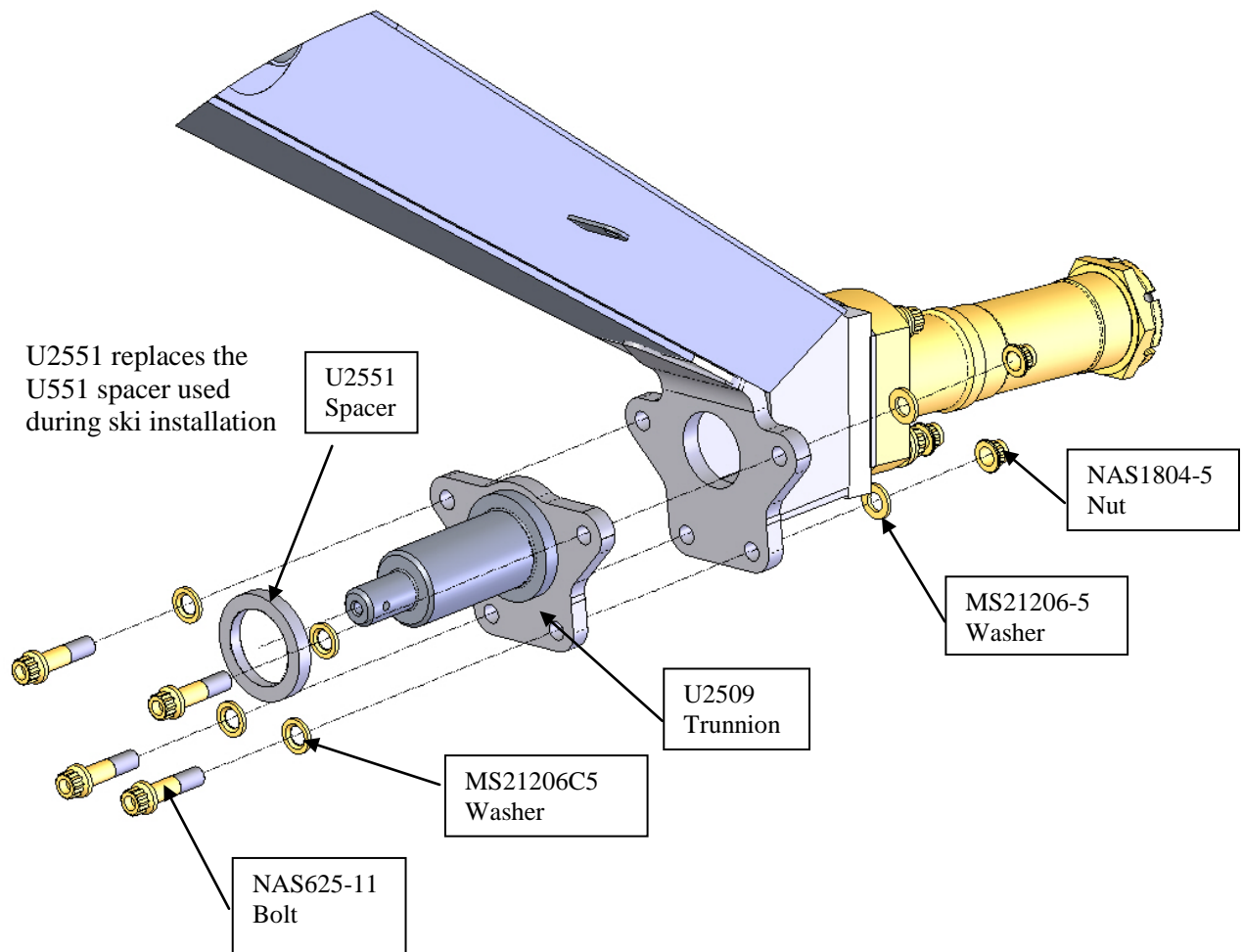

Figure 2 Ski Trunnion Installation

LOG BOOK CERTIFICATION:

Complete a Log Book entry stating “Service Instruction SI-32-08 Rev 0 has been accomplished, with/or without optional ski trunnion”